



USB TO DIGI XBEE®
WIRELESS PAN ADAPTER
FOR LAPTOPS & PCS



XSTICK®

The XStick provides local connectivity to a wireless Digi XBee network from a laptop or PC, enabling local commissioning of the network and its devices

Digi's XStick is an easy-to-use USB to Digi XBee Wireless Personal Area Network (WPAN) adapter, providing local connectivity to wireless networks. Simply plug the XStick into the USB port of a laptop or PC for instant access to an Digi XBee network and its connected devices. This compact, USB-powered wireless adapter enables local network configuration, diagnostics or device monitoring.

Two versions are available. The XStick 802.15.4 version is compatible with Digi XBee and Digi XBee-PRO® 802.15.4 devices and uses a fast multipoint network. The XStick ZigBee

version is compatible with Digi XBee or Digi XBee-PRO ZigBee devices and utilizes the ZigBee PRO Feature Set for robust mesh networks.

XStick is part of Digi's XBee family of solutions, offering users seamless wireless communication between devices, including adapters, routers and gateways.

BENEFITS

- USB to XBee Wireless Personal Area Network adapter (WPAN)
- Provides local connectivity for access, configuration and network commissioning
- Available in self-healing, self-configuring ZigBee mesh or fast 802.15.4 multipoint versions
- USB powered
- LEDs for power status and network association

RELATED PRODUCTS

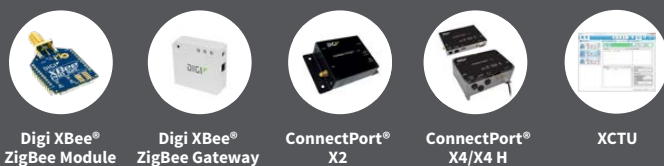

APPLICATION EXAMPLE

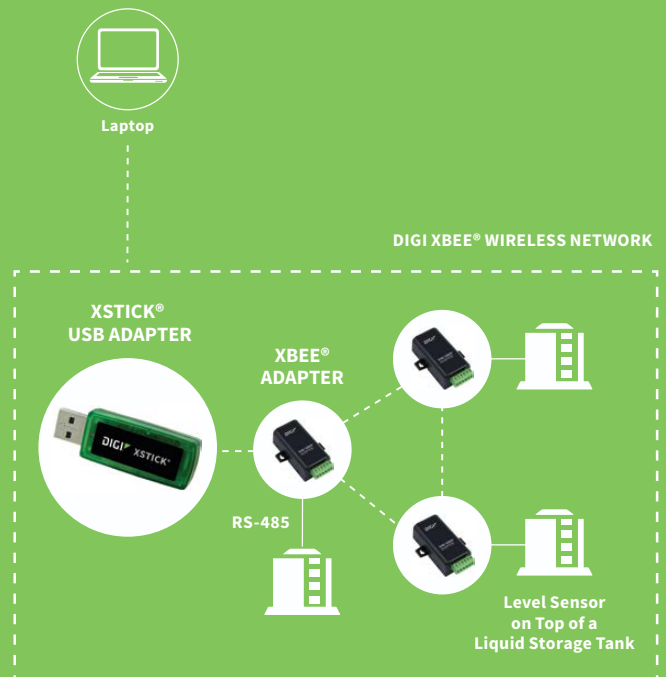

SPECIFICATIONS

XStick® ZigBee

XStick® 802.15.4

PERFORMANCE

| | | |
|--|-----------------------|---------------|
| INDOOR/URBAN RANGE | 66 ft (20 m) | 49 ft (15 m) |
| OUTDOOR/RF LINE-OF-SIGHT RANGE | 164 ft (50 m) | 131 ft (40 m) |
| TRANSMIT POWER OUTPUT (NOMINAL 25° C) | 2.8 mW (4.5 dBm) | 1 mW (0 dBm) |
| RF DATA RATE | 250 Kbps | |
| SERIAL INTERFACE DATA RATE (SOFTWARE SELECTABLE) | 1200 bps - 115.2 Kbps | |
| RECEIVER SENSITIVITY | -90 dBm | |

POWER REQUIREMENTS

| | | |
|--------------------|--|-------|
| SUPPLY VOLTAGE | 5V from USB port of PC | |
| TRANSMIT CURRENT | 51 mA | 64 mA |
| RECEIVE CURRENT | 47 mA | 64 mA |
| POWER-DOWN CURRENT | XStick should not be put into sleep mode | |

GENERAL

| | | |
|------------------------|---|--|
| FREQUENCY BAND | 2.4 GHz ISM | |
| DIMENSIONS (L X W X H) | 2.29 in x 0.80 in x 0.43 in (5.83 cm x 2.03 cm x 1.08 cm) | |
| OPERATING TEMPERATURE | -40° C to +85° C | |
| CONNECTOR | USB Type A | |
| ANTENNA OPTIONS | Internal only | |

NETWORKING & SECURITY

| | | |
|--|-----------------------|---|
| SUPPORTED NETWORK TOPOLOGIES | ZigBee Mesh | Point-to-Point, Point-to-Multipoint, Peer-to-Peer |
| NUMBER OF CHANNELS (SOFTWARE SELECTABLE) | 16 | |
| ADDRESSING OPTIONS | PAN, Channel, Address | |

REGULATORY APPROVALS

| | | |
|-----------------------|---------------|---------------|
| FCC PART 15.247 (USA) | MCQ-XSTICK2 | MCQ-XSTICK1 |
| IC (CANADA) | 1846A-XSTICK2 | 1846A-XSTICK1 |
| ETSI (EUROPE) | Yes | Yes |
| TELEC (JAPAN) | Yes | No |

XStick - Top View

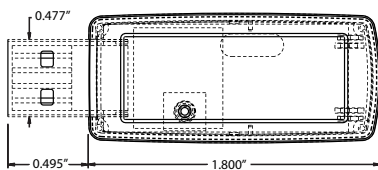

XStick - Side View

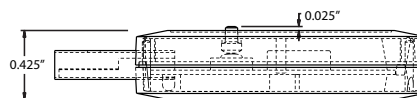

XStick - Connector

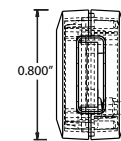

PART NUMBERS

DESCRIPTION

| | |
|--------|----------------------------|
| XU-Z11 | XStick USB Adapter, ZigBee |
| XU-A11 | XStick 802.15.4 |

DIGI SERVICE AND SUPPORT / You can purchase with confidence knowing that Digi is always available to serve you with expert technical support and our industry leading warranty. For detailed information visit www.digi.com/support.

© 1996-2018 Digi International Inc. All rights reserved.
All trademarks are the property of their respective owners.

91001463
C4/318

DIGI INTERNATIONAL WORLDWIDE HQ
877-912-3444 / 952-912-3444 / www.digi.com

DIGI INTERNATIONAL GERMANY
+49-89-540-428-0

DIGI INTERNATIONAL JAPAN
+81-3-5428-0261 / www.digi-intl.co.jp

DIGI INTERNATIONAL SINGAPORE
+65-6213-5380

DIGI INTERNATIONAL CHINA
+86-21-50492199 / www.digi.com.cn

