

# HPC-8424

## 4U Storage Chassis for ATX/EATX Serverboard with 24 Hot-swap Drive Bays

NEW



### Features

- 4U rackmount chassis supports EATX/ATX/uATX motherboard
- 24-bay hot-swappable 3.5"/2.5" SAS 12Gb/s drives or SATA 6Gb/s drives
- 4 x Hot-swappable NVMe drives supported via an optional riser card
- Supports 2 hot-swappable 2.5" drive bays at the rear
- Supports 80Plus redundant power supply

CE FCC

### Specifications

		Front	Rear
Drive Bay	3.5"/2.5"	24 (Hot-Swap)	-
	2.5"	-	2
Cooling	Fan	4 (8 cm)	
	Air Filter	-	
Front I/O Interface	USB	2	
Miscellaneous	LED Indicators	LAN1, LAN2, HDD, Power, and Information LED	
Environment		Operating	Non-Operating
	Temperature	0 ~ 35 °C (32 ~ 95 °F)	-40 ~70 °C (-40 ~158 °F)
	Humidity	10 ~ 95% @ 40 °C, non-condensing	10 ~ 95% @ 60 °C, non-condensing
	Vibration (5 ~ 500 Hz)	0.25 Grms	2 G
	Shock	5 G (with 11 ms duration, half sine wave)	
Physical Characteristics	Dimensions (W x H x D)	438 x 176 x 620 mm (17.24" x 6.93" x 24.41")	
	Weight	31 kg (without hard drivers)	

### Front View



### Rear View



Dimensions

Unit: mm [inch]

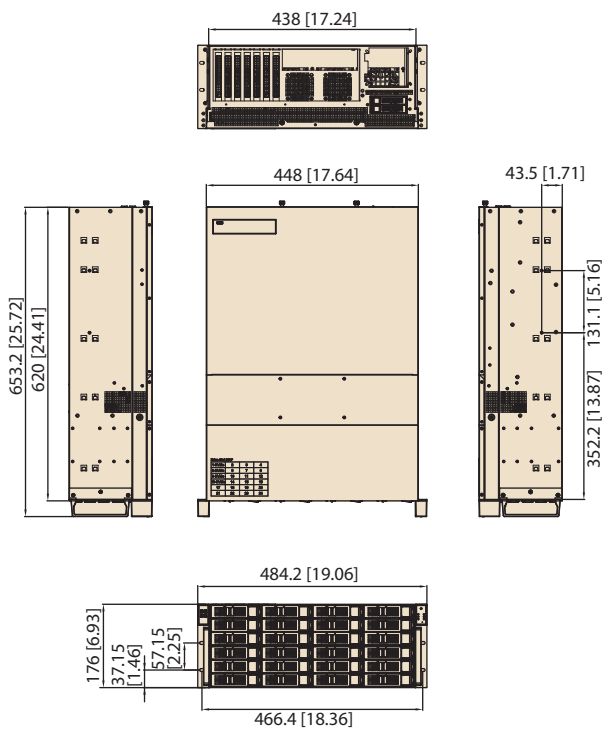

Ordering Information

Part Number	Chassis Depth	Built-in PSU Configuration	Front HDD Backplane	Rear HDDs (2 x 2.5")	Default Rail Kit	Motherboard Form-factor	Expansion Slots
HPC-8424SE-80RB1	620mm	RPSU 800W	SAS12Gb/s	Hot-Swap	26"	EATX, ATX, uATX	x6" Full Height

Note: one slot will be occupied by an SAS RAID card.

Packing List

Part Number	Description	Quantity
9680017375	26" Slide Rail Kit	1

Optional Accessories

Part Number	Description
9891821221E	PCIe x16 Riser card for 4-port NVMe drives
1700025064-01	Internal SAS cable (12G) SFF8643 to SFF8643, 60cm
ASR-1000K-00A1E	JBOD module